

**WALTEK'S SERIES 7000-UmaxPLUS - HB
SEMI & UNITIZED FRAMING SYSTEM STANDARD
PROFILE SIZES**

NOTES: PROJECT SPECIFIC CUSTOM PROFILE SIZES ARE AVAILABLE UPON REQUEST.

EXTERIOR COVER OPTIONS

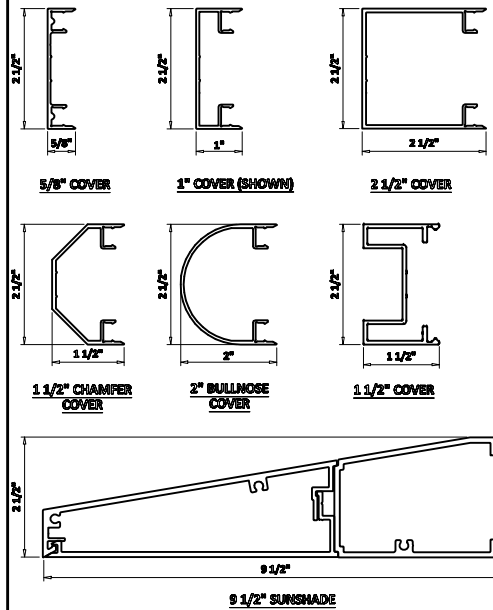

NOTES: CUSTOM EXTRUSION PROFILES ARE ALSO AVAILABLE.

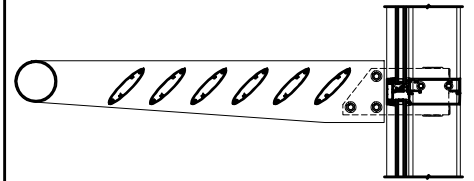

PROJECTING SUNSHADES AND/ OR LIGHT SHELVES AVAILABLE

SILL TRIM OPTIONS

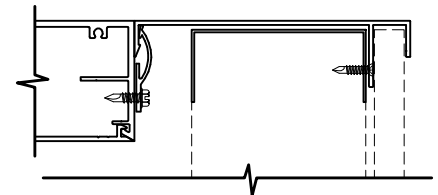

NOTES: PROJECT SPECIFIC CUSTOM SILL DEPTHS AND PROFILES ARE AVAILABLE UPON REQUEST.

TYPICAL PERFORMANCE LEVELS

AIR: 0.06 CFM/SQ.FT. AT 6.24 LBS/SQ. FT. PER ASTM E283

WATER: 12 LBS/SQ. FT. PER ASTM E331

U-VALUE: 0.32 TO 0.39 - VALUE DEPENDANT ON GLAZING SELECTED PER AAMA 507 & NRFC-100-200-500 HIGHER PERFORMING VERSIONS ARE AVAILABLE FOR SPECIFIC PROJECT NEEDS.

FINISHING OPTIONS

- EXTERIOR: KYNAR 500/ HYLAR 5000 ANODIZED
- INTERIOR: KYNAR 500/ HYLAR 5000 ACRYLIC ANODIZED

GLAZING OPTIONS

7000-Umax SERIES FRAMING SYSTEMS ACCOMMODATE GLAZING OPTIONS FROM 1 3/4" DOUBLE INSULATED

VISIT US ON THE WEB AT: WWW.WALTEKLTDCOM - OR E-MAIL US AT SALES@WALTEKLTDCOM

CINCINNATI: (513) 577-7980

MORE SYSTEM OPTIONS



SYSTEM
**WALTEK'S SERIES 7000-UmaxPLUS - HB
SEMI & UNITIZED
FRAMING SYSTEM**

THE ABOVE INFORMATION IS FOR A TYPICAL APPLICATION. CUSTOMIZATION OF ALL COMPONENTS AND PERFORMANCE LEVEL IS AVAILABLE TO MEET DESIGN CRITERIA.

WANT TO LEARN MORE ABOUT OUR WALL SYSTEMS OR WISH TO DISCUSS PROJECT SPECIFIC DETAILS, PLEASE CONTACT US AT THE ADDRESS & PHONE NUMBER SHOWN.