

**WALTEK'S SERIES 7000
2 1/4" FRONT SET FRAMING SYSTEM**

NOTES: PROJECT SPECIFIC CUSTOM PROFILE SIZES ARE AVAILABLE UPON REQUEST.

EXTERIOR COVER OPTIONS

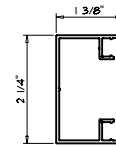

1 3/8" COVER

NOTES: CUSTOM EXTRUSION PROFILES ARE ALSO AVAILABLE.

SILL TRIM OPTIONS

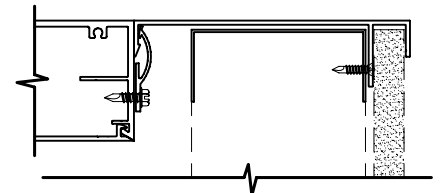

NOTES: PROJECT SPECIFIC CUSTOM SILL DEPTHS AND PROFILES ARE AVAILABLE UPON REQUEST.

FINISHING OPTIONS

- EXTERIOR:
KYNAR 500/ HYLAR 5000
ANNODIZED
- INTERIOR:
KYNAR 500/ HYLAR 5000
ACRYLIC
ANNODIZED

GLAZING OPTIONS

7000 SERIES FRAMING SYSTEMS
ACCOMMODATE GLAZING OPTIONS FROM 1/4"
MONOLITHIC TO 1" INSULATED.

TYPICAL PERFORMANCE LEVELS

AIR: 6.24 LBS/SQ. FT. PER ASTM E283

WATER: 10 LBS/SQ. FT. PER ASTM E331

CRF: 55 PER AAMA 1503

HIGHER PERFORMING VERSIONS ARE
AVAILABLE FOR SPECIFIC PROJECT NEEDS.

VISIT US ON THE WEB AT: WWW.WALTEKLTD.COM - OR E-MAIL US AT SALES@WALTEKLTD.COM

CINCINNATI: (513) 577-7980

NASHVILLE: (615) 251-7040

SYSTEM



WALTEK'S SERIES 7000 2 1/4"
FRONT SET FRAMING SYSTEM

THE ABOVE INFORMATION IS FOR A TYPICAL
APPLICATION. CUSTOMIZATION OF ALL
COMPONENTS AND PERFORMANCE LEVEL IS
AVAILABLE TO MEET DESIGN CRITERIA.

IF YOU WOULD LIKE TO LEARN MORE ABOUT OUR WALL SYSTEMS OR WISH TO DISCUSS PROJECT
SPECIFIC DETAILS, PLEASE CONTACT US AT THE ADDRESS & PHONE NUMBER SHOWN.